

VERTICAL PENETRATION NOTES:

- ✕ A - 200mm x 200mm BUILDERSWORK PENETRATION
- B - 100mm X 100mm BUILDERSWORK PENETRATION
- C - 110Ø CAST IN SVP/RW PIPE
- D - 50Ø CAST IN SVP PIPE
- E - CAST IN WADE D1004 GULLY BODY
- ✖ F - CAST IN SWAN NECK FOR ROOF TOP SERVICES
- ✕ G - 300mm x 250mm BUILDERSWORK PENETRATION
- ✕ H - 300mm x 300mm BUILDERSWORK PENETRATION
- ✕ I - 90Ø CAST IN DUCT
- ✕ J - 125Ø CAST IN DUCT
- ✕ K - 200Ø CAST IN DUCT

HORIZONTAL PENETRATION NOTES:

- | | |
|--|---|
| | 1. 200mm x 50mm BUILDERSWORK PENETRATION |
| | 2. 250mm x 100mm BUILDERSWORK PENETRATION |
| | 3. 200mm x 200mm BUILDERSWORK PENETRATION |
| | 4. 500mm x 200mm BUILDERSWORK PENETRATION |
| | 5. 800mm x 200mm BUILDERSWORK PENETRATION |
| | 6. 1000mm x 200mm BUILDERSWORK PENETRATION |
| | 7. 1200mm x 200mm BUILDERSWORK PENETRATION |
| | 8. 1500mm x 200mm BUILDERSWORK PENETRATION |
| | 9. 1200mm x 350mm BUILDERSWORK PENETRATION |
| | 10. 1400mm x 250mm BUILDERSWORK PENETRATION |
| | 11. 1200mm x 250mm BUILDERSWORK PENETRATION |

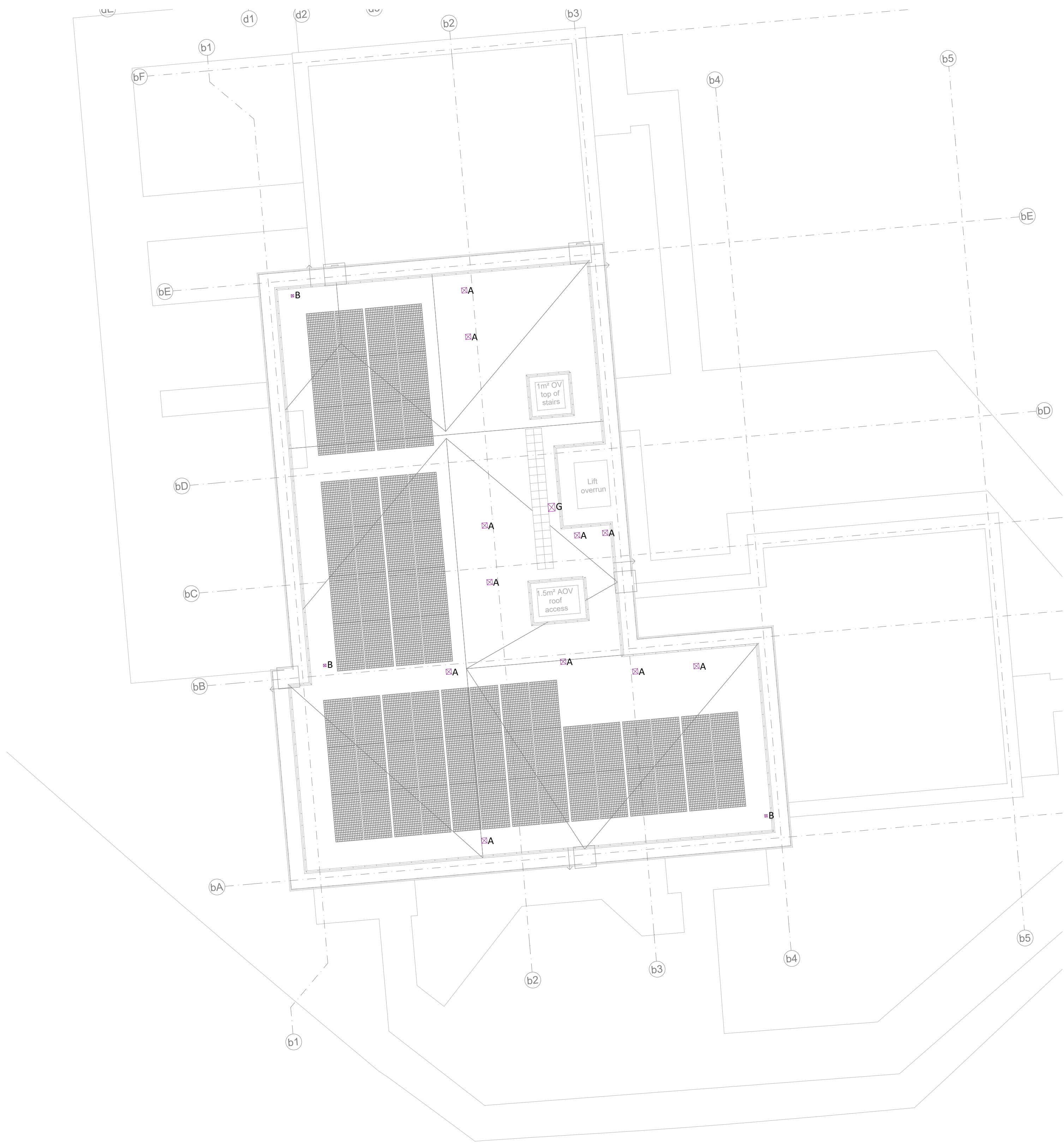

C01	05.06.24	CONSTRUCTION ISSUE	D.I
P02	20.10.22	RISER BUILDERSWORK HOLES ADDED	D.I
P01	24.06.22	PRELIMINARY ISSUE	L.B

Rev	Date	Description	Issued By
Client:			

Bellway

Project:

**BARKING SITE H WEST
BARKING RIVERSIDE**

Title:

**BLOCK B
ROOF LEVEL
BUILDERSWORK LAYOUT**

Drawn:	Scale:	Sheet Size:	Checked:
L.B	1:100	A1	N.G

Drawing No:	Project No	Originator	Zone	Level	File Type	Role	Doc No
1108 - ASH - B - RF - DR - D - 9304							

Purpose of Issue:	Status:	Revision:
CONSTRUCTION	S4	C01

THIS DRAWING SHOULD NOT BE SCALED FROM. ALL DIMENSIONS ARE NOMINAL. TO BE READ IN CONJUNCTION WITH ARCHITECTS AND ENGINEERING DRAWINGS AND SPECIFICATIONS. REPORT ANY DISCREPANCIES TO ASHSTONE MEP LTD. © ASHSTONE MEP LTD